

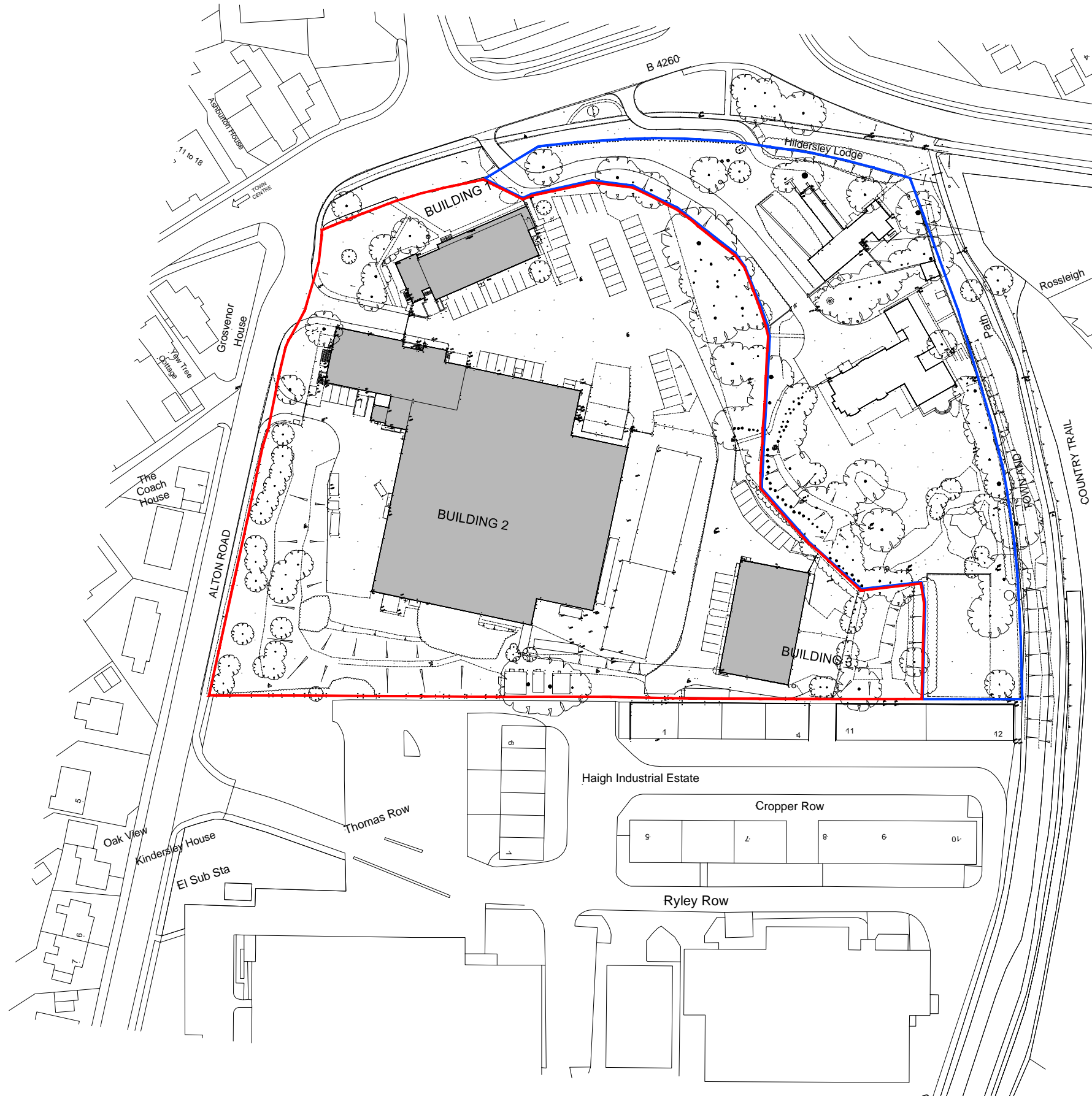

clients logo

SITE AREA:
19,382 m²



2	22.02.18	Amended to consultant's comments	AW
1	21.02.18	Amended to consultant's comments	AW
REV	DATE	DESCRIPTION	BY

IN CASE OF DOUBT OR DISCREPANCIES PLEASE REFER TO ARCHITECT FOR INSTRUCTIONS.
DRAWING AND SUITABILITY NUMBERS IN ACCORDANCE WITH BS1192:2007.
THIS DRAWING SHOULD NOT BE SCALED.
THIS DRAWING IS COPYRIGHT.

SUITABILITY NUMBER KEY:

WIP	S0 - Work in Progress*	DOCUMENTATION - SIGN-OFF
SHARED	S1 - Fit for co-ordination**	A - Fit for construction
	S2 - Fit for information	B - Fit for construction, with comments
	S3 - Fit for internal review and comment	C - Comprehensive revisions needed
	S4 - Fit for construction approval	ARCHIVE
DOCUMENTATION	D1 - Fit for costing	AB - As Built
	D2 - Fit for tender	FC - Final Construction
	D3 - Fit for contractor design	* For internal pre-issue usage only.
	D4 - Fit for manufacture/procurement	** For model file usage only.

boyesrees
4th Floor, Greyfriars House
Greyfriars Road, Cardiff CF10 3AL
Tel: 029 2055 8900 Fax: 029 2039 9592
www.boyesrees.co.uk
Registered office: As above Reg No. 295 1683 (England & Wales)

PROJECT TITLE:
Proposed Lidl Store at Alton Road Ross-on-Wye

DRAWING TITLE:
Site Location Plan

DRAWN BY: AW **SCALE:** 1:1250 @ A3

JOB NO: 5989 **DATE:** DEC. 17

SUITABILITY: S0 **REVISION:** 2

PROJECT	ORIGIN	VOLUME	LEVEL	TYPE	DISCIP.	NUMBER
5989	BR	V01	00	DR	A	010000

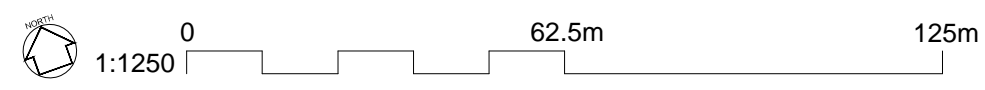

C:\Users\NCT\Documents\14\Proposed Lidl Store at Alton Road Ross-on-Wye\Drawings\Site Location Plan.dwg
 Date: 17/12/2017 10:58:11 AM
 User: NCT